

# AerWave (Touchless + Wireless Switch)

## Instruction Manual

AerWave is a high-performance touch-free, wireless switch. It is designed to activate automatic doors and similar devices by detecting hand or object movement without physical contact. For the safe and accurate use of this product, please read this instruction manual carefully.



## 1 Product components and specification

Components	AerWave	1EA
	Double-sided Tape	1EA
	Battery (CR123A)	2EA
	Fixing Screw (4×16)	2EA
	Front Plate (2 types)	1EA (Hand and Wheelchair)
	User Manual	1Copy
Specifications	Power Supply	DC3V
	Technology	Infrared - Reflective
	Detection Range / Method	1~15cm ±5cm / LED or BUZZER
	Detecting Target	Hand or Object (Touchless) ※ Detecting distance varies depending on the color of the object
	Wireless transmission distance	<10m (2m or less when attached a metal structure)
	Response Time	<1sec.
	Battery Life	Approx. 12 months (500 usages per day)
	Current Consumption	<0.5mWh
	Operating Temp / Humidity	-20℃~50℃ / 0~90%
	IP Rating	IP65
	Dimensions	95 x 95 x 20 mm

## 2 General Information

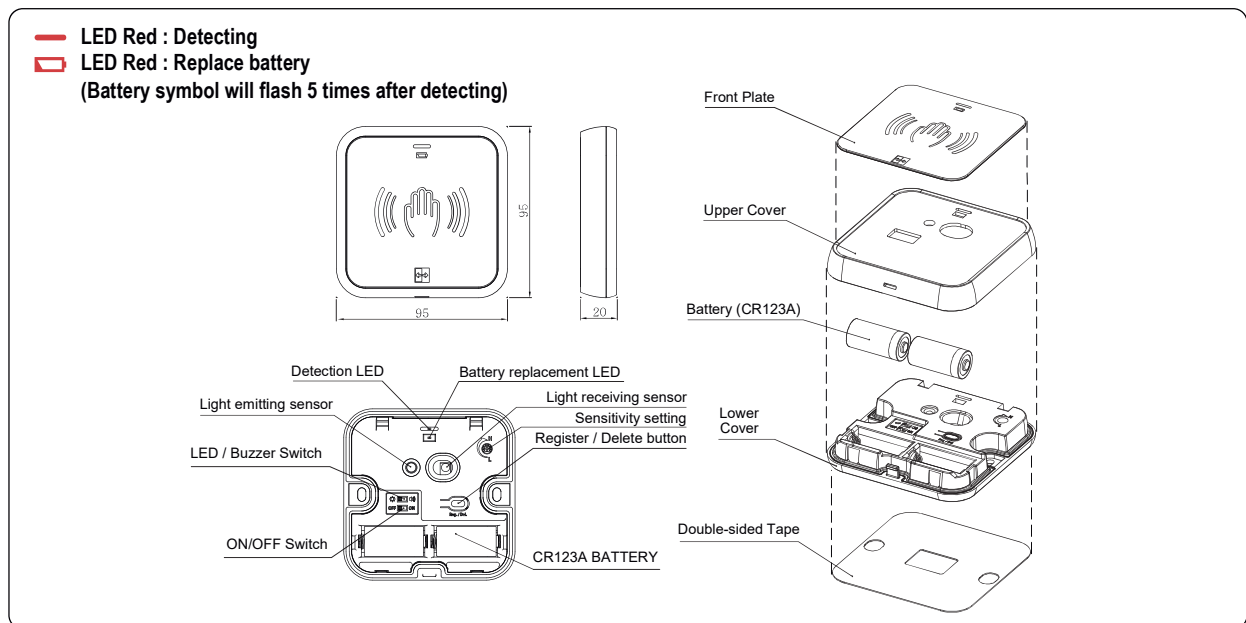

### 3 Installation Guide

- 1** If the protective film is not removed from the Front Plate it may interfere with the function of this product. Therefore remove the protective film from the Front Plate and disassemble the AerWave cover using a  screwdriver.

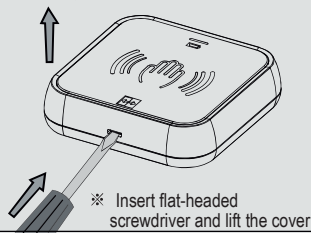

- 2** Install batteries and turn the AerWave ON. Register the transmitter with a receiver using the Register/Delete button (See section 4).

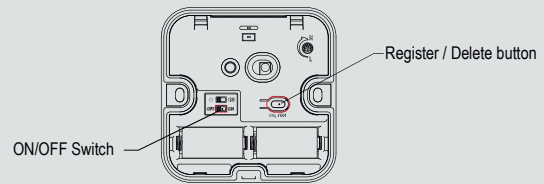

- 3** Attach the Lower Cover to where you want to install the sensor using the Double-sided Tape and/or screws provided.

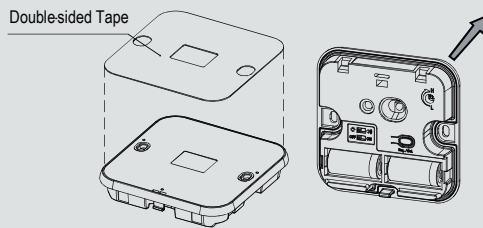

- 4** Set the detection distance as required by adjusting the Sensitivity setting using a screwdriver. Select whether you want detection to be indicated with an LED or a Buzzer, then attach the Upper Cover to the sensor.

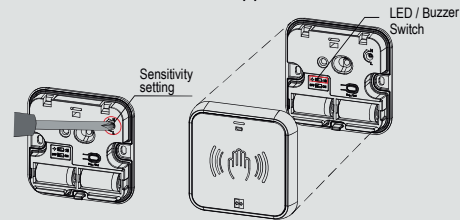

### 4 Registering the AerWave Transmitter with the WR-24 Receiver (sold separately)

※ Up to 10 AerWave sensors can be registered with one WR-24 receiver.

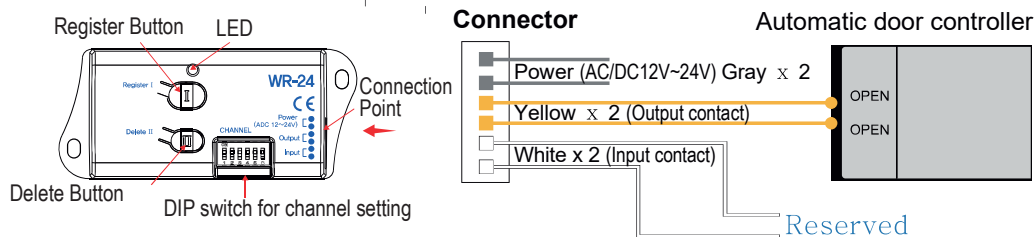

※ Make sure to check that all dip switches are in the down (OFF) position before proceeding

#### 1. Registering an AerWave Transmitter with a WR-24 Receiver

- Connect power to the WR-24 receiver.
- Press the Register/Delete button on the AerWave switch for 3 seconds whilst simultaneously pressing the Register I button on the WR-24 receiver.
- ● The red LED will flash on the WR-24 to indicate registration.

#### 2. Deleting an AerWave Transmitter from a WR-24 Receiver

- Connect power to the WR-24 receiver.
- Press the Register / Delete button on the AerWave switch for 3 seconds whilst simultaneously pressing the Delete II button on the WR-24 receiver.
- ● The blue LED will flash on the WR-24 to indicate deletion.

#### 3. Deleting all AerWave Transmitters from a WR-24 Receiver

- Press the Register I button and Delete II button on the WR-24 receiver at the same time for 5 seconds.
- ● The blue LED will flash three times indicating that all registered AerWave transmitters have been deleted.



### 5 Precautions

- 1** Remove the protective film attached to the front plate



- 2** Do not install in places exposed to strong sunlight

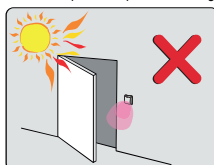

- 3** Avoid moving objects in front of the sensor

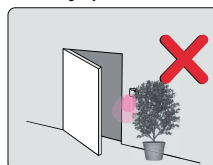

- 4** Do not install in humid areas

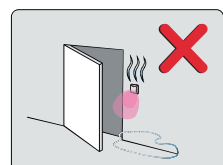

# Using the WR-24 Receiver with the AerWave Switch (sold separately)

※ Up to 10 AerWave sensors can be registered with one WR-24 receiver.

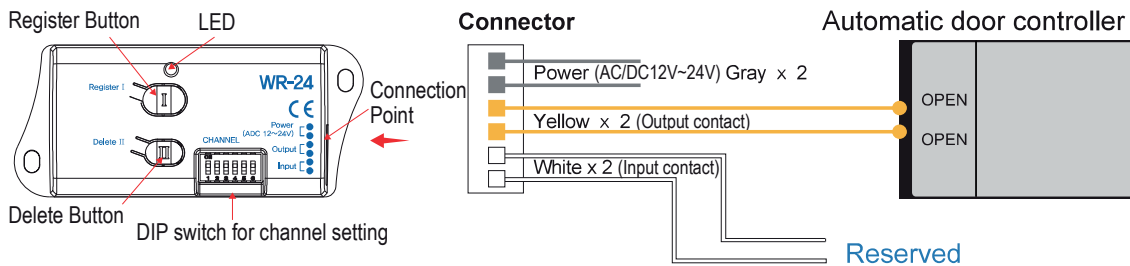

※ Make sure to check that all dip switches are in the down (OFF) position before proceeding



## 1. Registering an AerWave Transmitter with a WR-24 Receiver

- Connect power to the WR-24 receiver.
- Press the Register/Delete button on the AerWave switch for 3 seconds whilst simultaneously pressing the Register I button on the WR-24 receiver.
- ● The red LED will flash on the WR-24 to indicate registration.

## 2. Deleting an AerWave Transmitter from a WR-24 Receiver

- Connect power to the WR-24 receiver.
- Press the Register / Delete button on the AerWave switch for 3 seconds whilst simultaneously pressing the Delete II button on the WR-24 receiver.
- ● The blue LED will flash on the WR-24 to indicate deletion.

## 3. Deleting all AerWave Transmitters from a WR-24 Receiver

- Press the Register I button and Delete II button on the WR-24 receiver at the same time for 5 seconds
- ● The blue LED will flash three times indicating that all registered AerWave transmitters have been deleted.

# Using the WR-24 Receiver with the WT-400 Switch (sold separately)

You can select one of the following two methods to register a transmitter/receiver (pairing)

**⚠ Do not use a combination of double-sided tape and screws when installing the WR-24 receiver. It may cause the lid to open.**

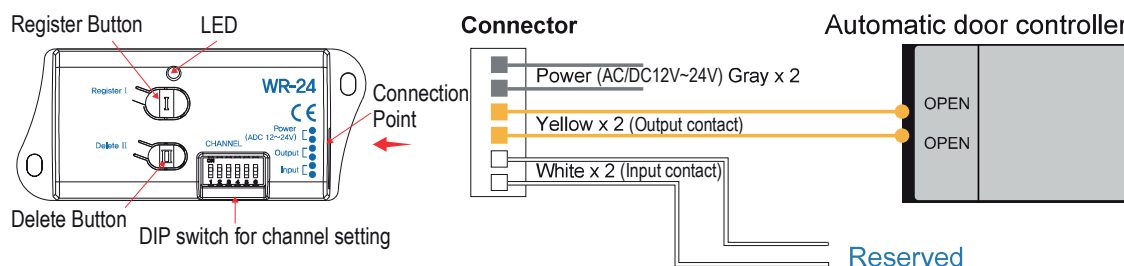

## ① Method 1: Registration using dip switches

Set the dip switches on the WT-400 transmitter and WR-24 receiver in the same sequence with power to the WR-24 disconnected.

- ※ Pairing cannot be done if the all DIP switches on both the WT-400 and WR-24 are in the OFF position.
- ※ An unlimited number of WT-400 transmitters can be registered with one WR-24 receiver.



## ② Method 2: Registration using push buttons

Registration using push buttons should be done when the dip switches on the WT-400 and WR-24 are in the OFF position.



### 1. How to register

- Connect the power to the WR-24 receiver.
- Press the WT-400 switch for 3 seconds whilst simultaneously pressing the Register I button on the WR-24 receiver.
- ● The red LED will blink once indicating that registration is complete.

※ Up to 10 WT-400 transmitters can be registered with one WR-24 receiver using this method.

### 2. How to delete a WT-400 Transmitter

- Connect the power to the WR-24 receiver.
- Press the WT-400 switch for 3 seconds whilst simultaneously pressing the Delete II button on the WR-24 receiver.
- ● The blue LED will blink once indicating that deletion is complete.

### 3. Deleting all registered WT-400 Transmitters

- Press the Register I button and Delete II button on the WR-24 receiver at the same time for 5 seconds
- ● The blue LED will flash three times indicating that all registered WT-400 transmitters have been deleted.